

# THOMPSON VACUUM PRESSURE UNITS

## TTI-1106 LIQUID ENTRY PREVENTER

MILD STEEL OR 316 S.S. BODY  
TYPICAL 3" & 4" PIPE SIZE

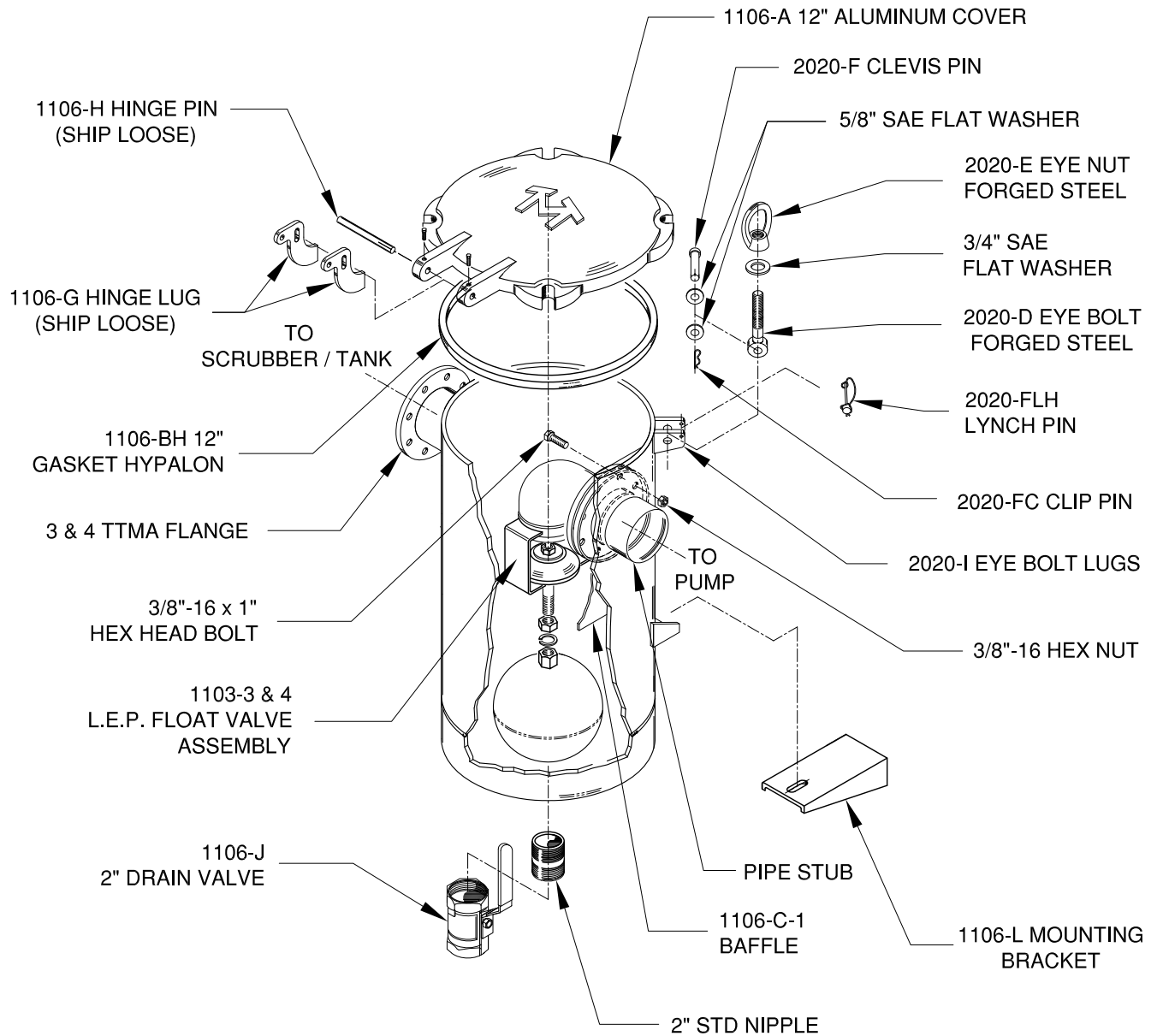

NOTE: TTI-1106-3 IS AVAILABLE WITH A TTI-1103-4 FLOAT VALVE  
ASME 50# DESIGN PRESSURE AND FULL VACUUM  
17" W x 14" D x 28" H (APPROX.)  
SHIPPING WEIGHT (APPROX.) 110 LBS.

**THOMPSON TANK, INC.**

P.O. BOX 790 • LAKEWOOD, CA 90714-0790 • TEL: (800) 421-7545 • FAX: (562) 869-7214

[www.thompson-tank.com](http://www.thompson-tank.com)



Thompson Units are manufactured under U.S. Patent No. 3315611, 3347263, 3398513 and 3971400 Patented Canada 1969

©Reg. U.S. Pat. & TM Off.